

The drawings copyright and must not be reproduced or disseminated without our prior permission.
This drawing is to be read in conjunction with all relevant conditions, specialist manufacturers details and specifications.
Acceptance of drawings is to be taken as confirmation that the drawings shall be drawn to our standards.
Admission to site is at the discretion of the site manager.
Any further information incorporated within this drawing cannot be guaranteed as accurate unless confirmed by field surveys.

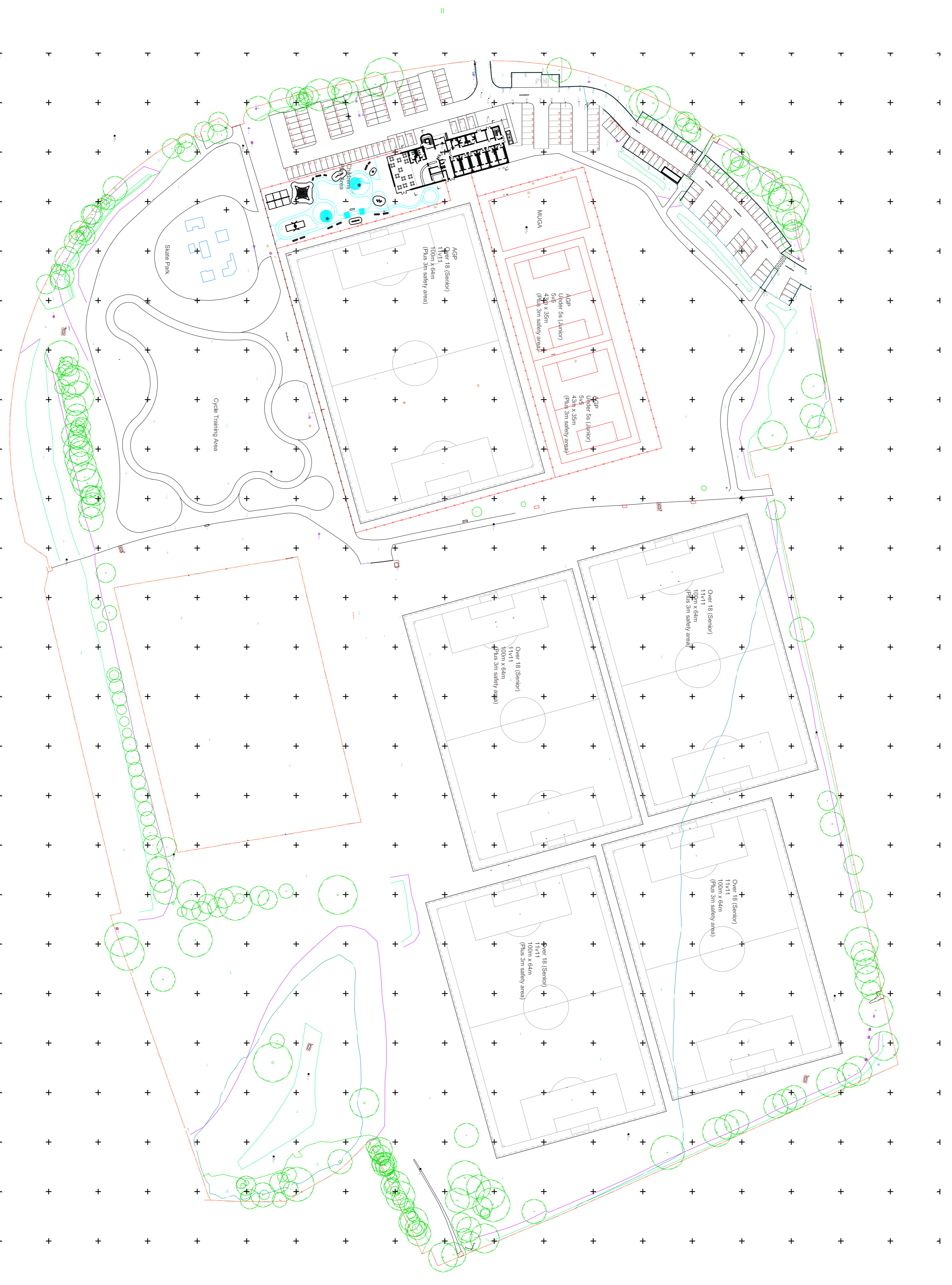

PROPOSED SITE PLAN 1:1000

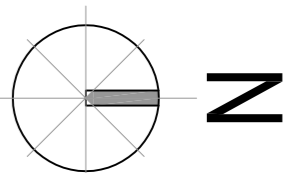
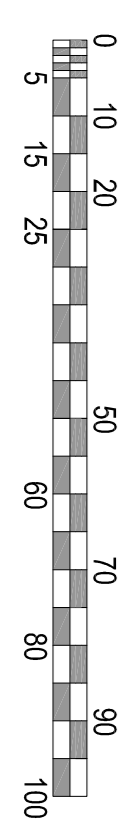

REV	DESCRIPTION	BY	CHKD	DATE
P01	Preparation base	RSS	AW	15/11/2018
P02	General address to staff members from the Chairman of the Board.	RSS	SRP	15/11/2018
P03	General address to staff members from the Chairman of the Board.	RSS	SRP	26/11/2018
P04	General address to staff members from the Chairman of the Board.	RSS	AW	08/12/2018
P05	General address to staff members from the Chairman of the Board.	RSS	SRP	11/12/2018
P06	General address to staff members from the Chairman of the Board.	RSS	SRP	12/12/2018
P07	General address to staff members from the Chairman of the Board.	RSS	SRP	02/01/2019
P08	General address to staff members from the Chairman of the Board.	RSS	SRP	06/01/2019
P09	General address to staff members from the Chairman of the Board.	RSS	DS	31/01/2019
P10	General address to staff members from the Chairman of the Board.	RSS	RA	06/02/2019
P11	General address to staff members from the Chairman of the Board.	RSS	AW	14/02/2019
P12	General address to staff members from the Chairman of the Board.	RSS	AW	28/02/2019

PURPOSE: PLANNING

PROJECT: Newcastle Parklife Hubs
Blakeley Sports Ground
for Newcastle City Council

DESCRIPTION: Proposed Site Masterplan

DRAWN BY:	SCALE:	SHEET SIZE:	DATE:
RSS	1:1000	A1	13/11/2018

PROJ NO	DATE	VOLUME	LEVEL	TYPE	FOUR	NUMBER	SUBMITTER	REV
18/186	HL	XX	DR	A		1600	S4	P12

H L
HOWARTH
LITCHFIELD

L048 Baker, Dunham, Duff Hill, TOWNSEND (0191) 384447 E: hlf@hlfd.co.uk
L049 Baker, Dunham, Duff Hill, TOWNSEND (0191) 384447 E: hlf@hlfd.co.uk
L050 Baker, Dunham, Duff Hill, TOWNSEND (0191) 384447 E: hlf@hlfd.co.uk

© Copyright and All Intellectual Property Rights reserved by Howarth Litchfield Partnership Limited